



Univerzálny montážny plán

Domček so sedlovou strechou

Záhradné domčeky

MICHAL ZELMAN

www.domceknazahradu.sk

Základný rošt pre podlahu (vzorový – v závislosti na type domčeka)

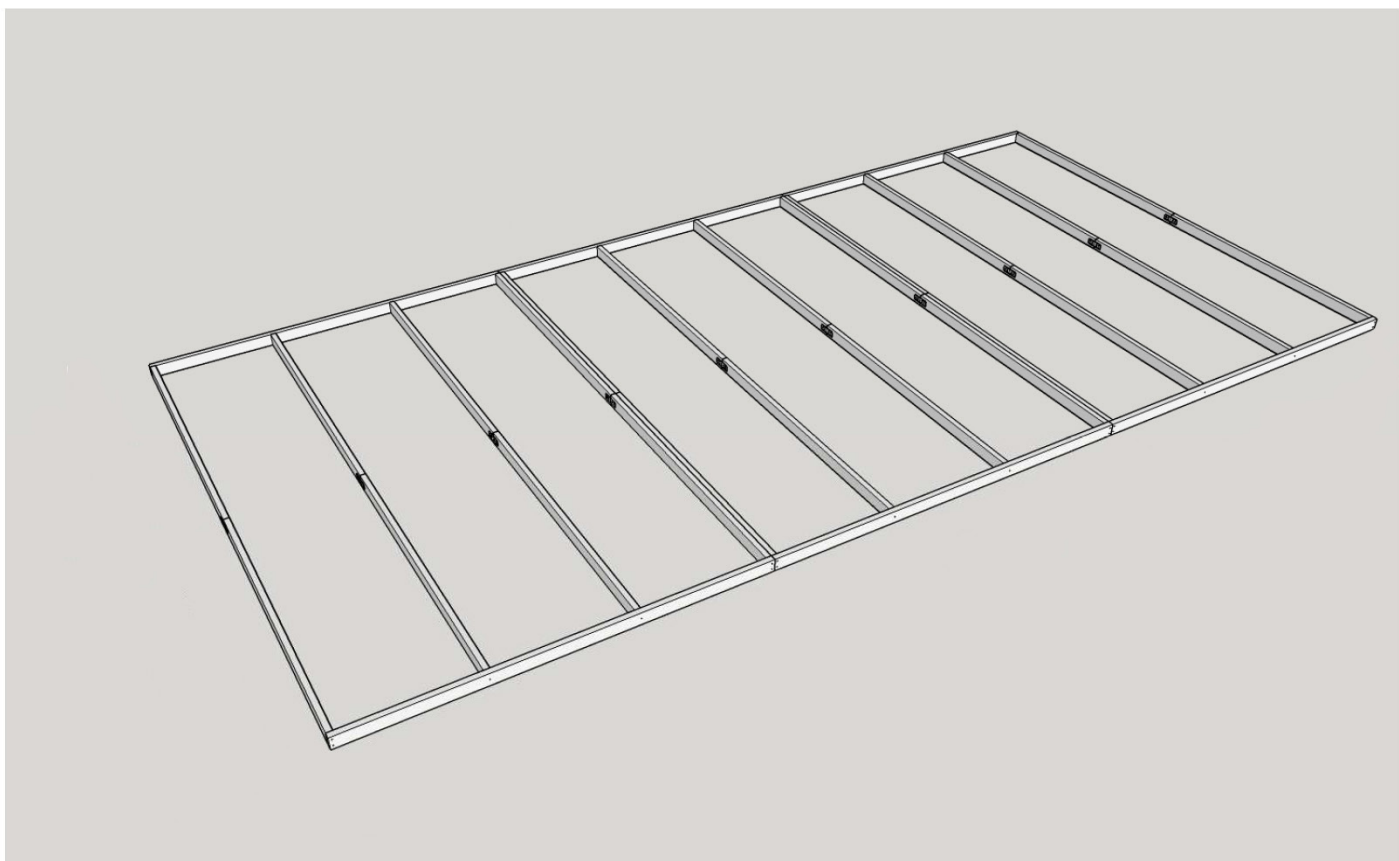
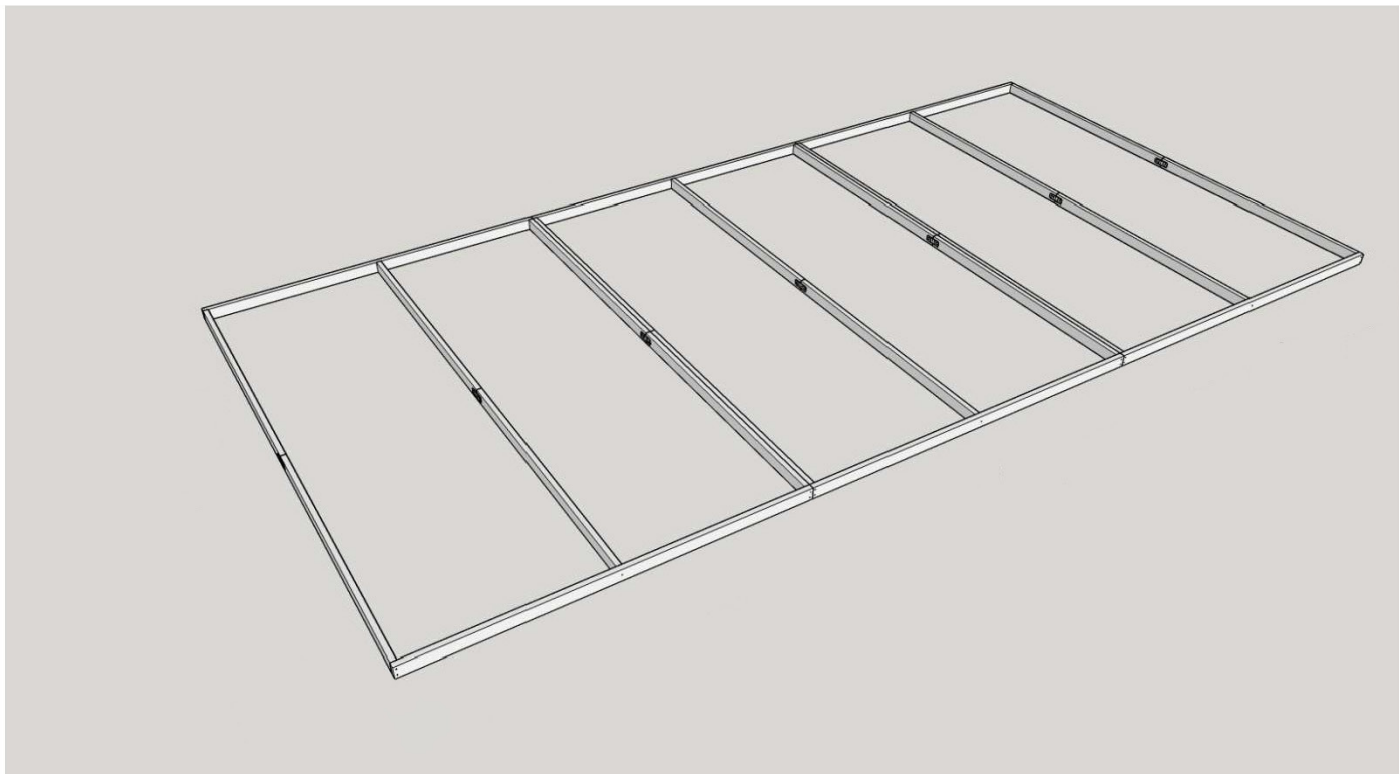

Kladenie podlahy (vzorové – v závislosti na type domčeka)

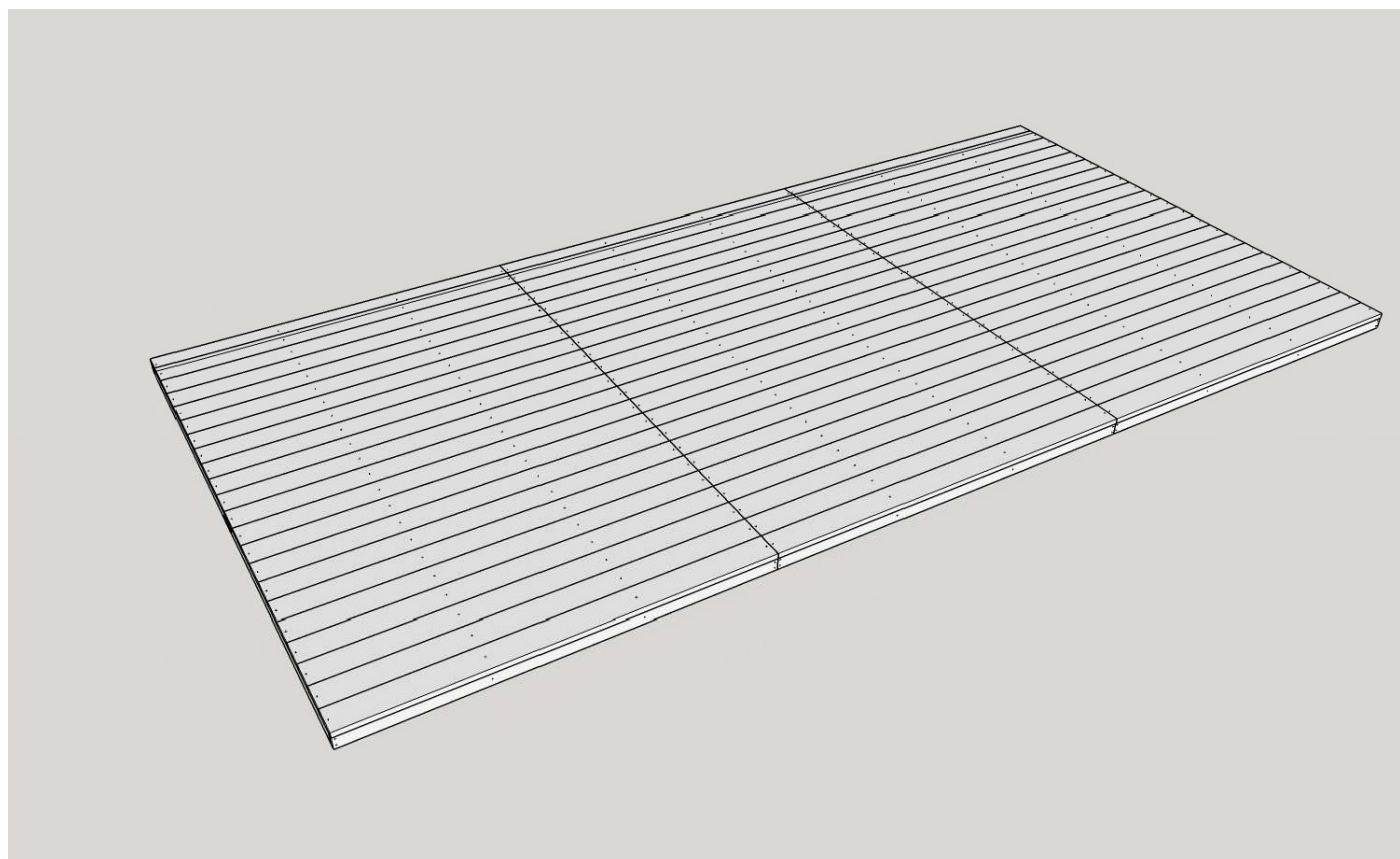
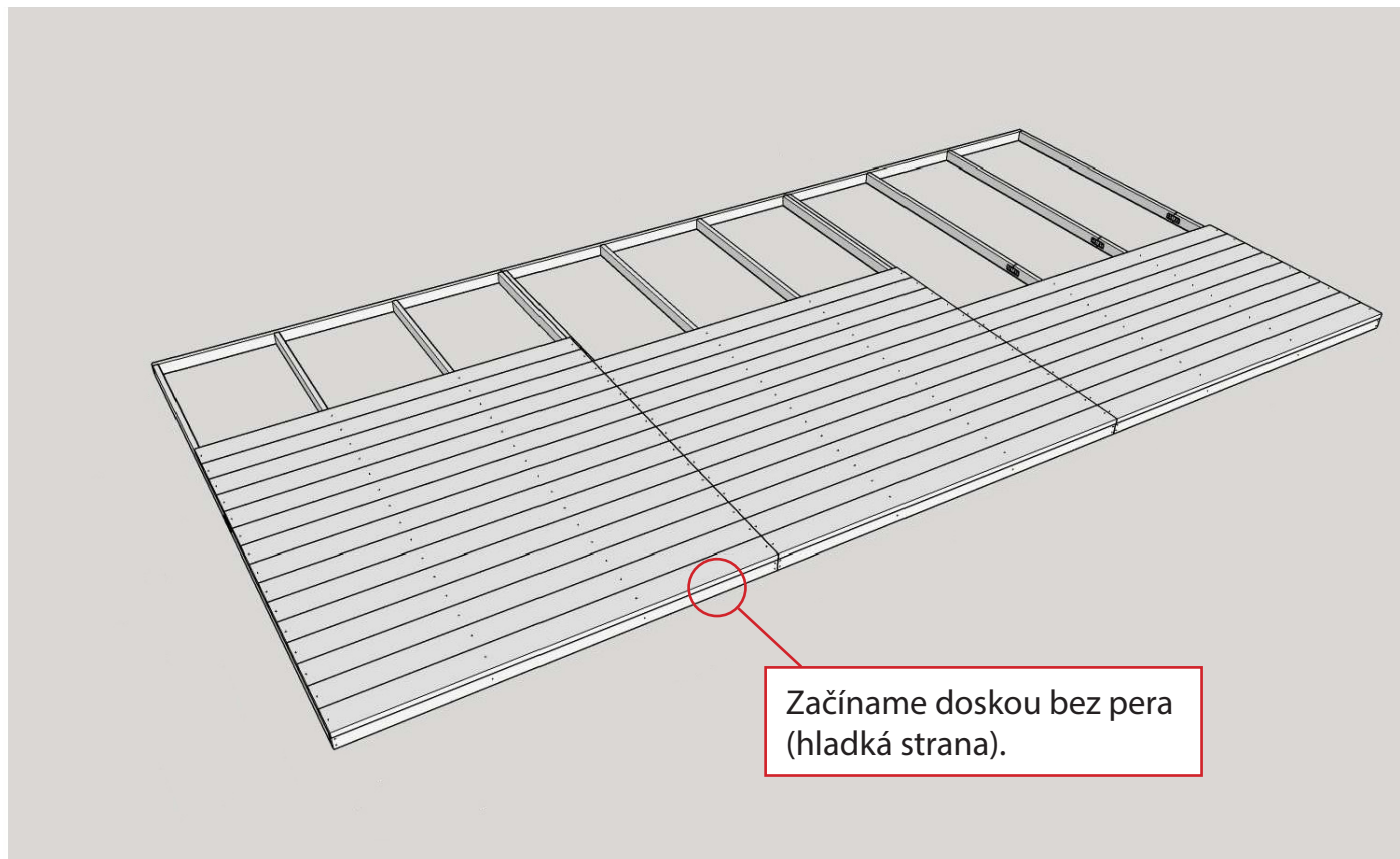

Uloženie stien domčeka

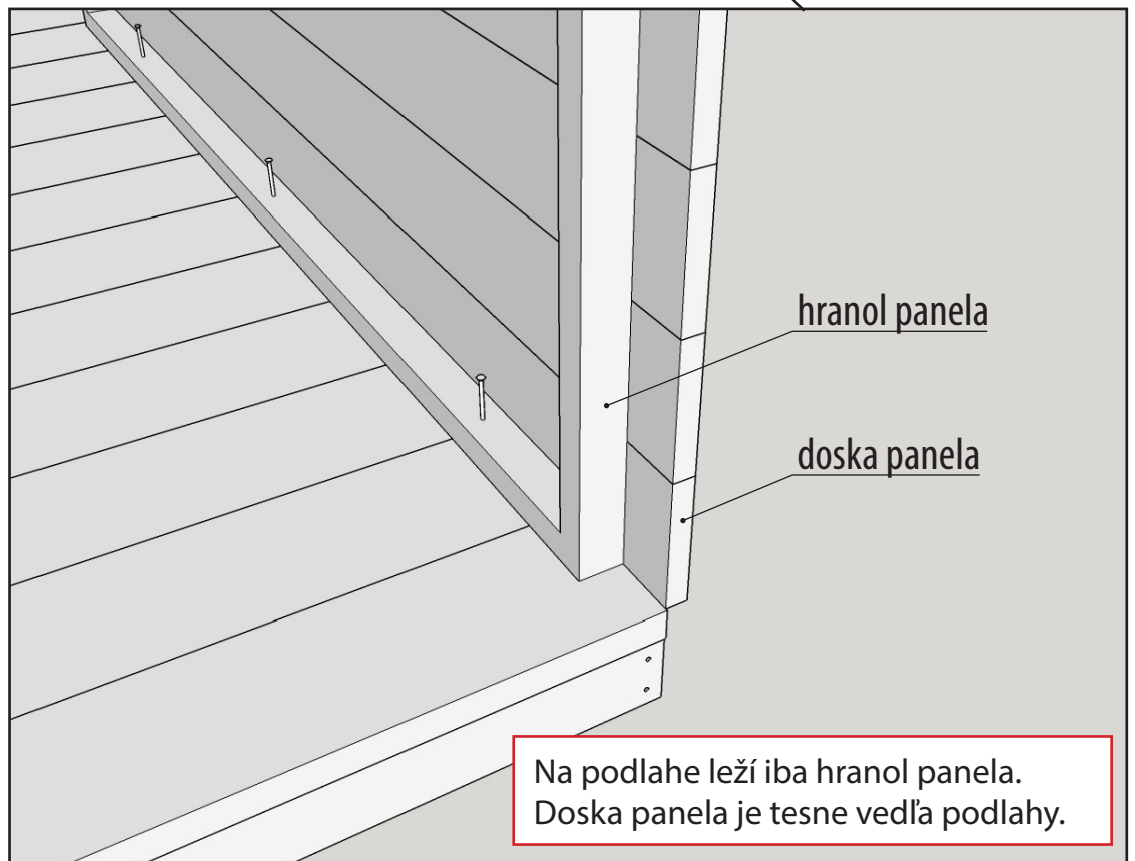
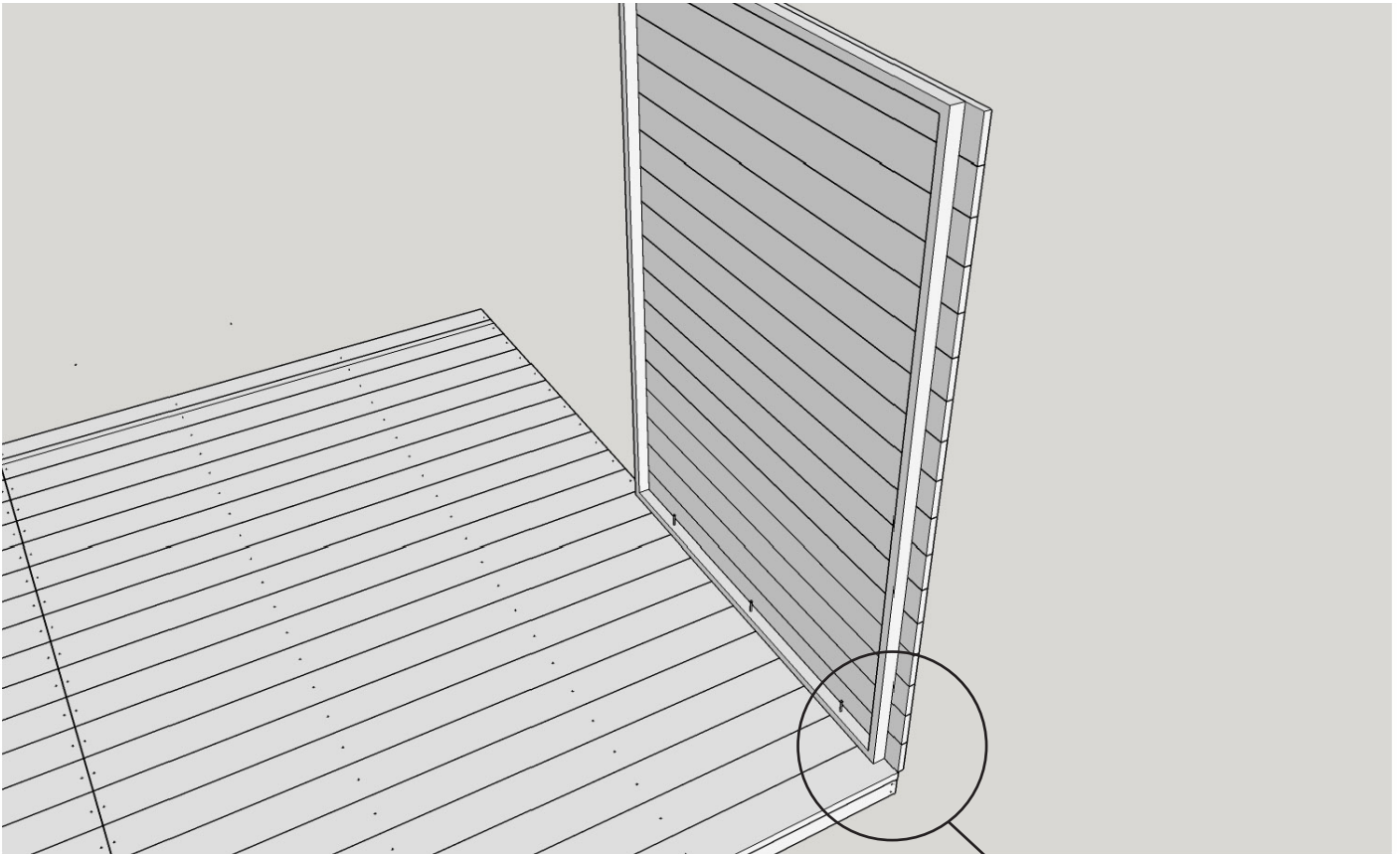

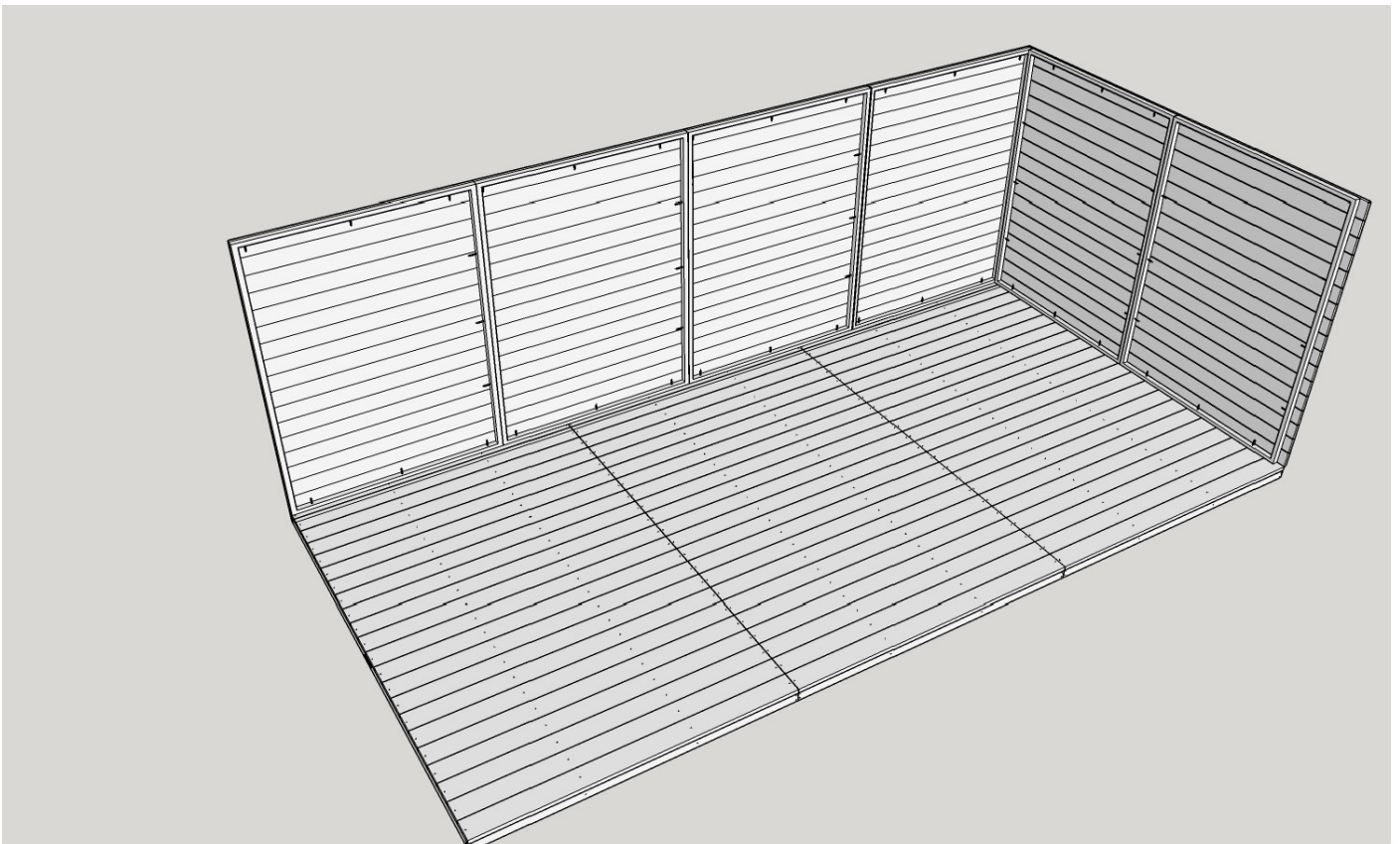
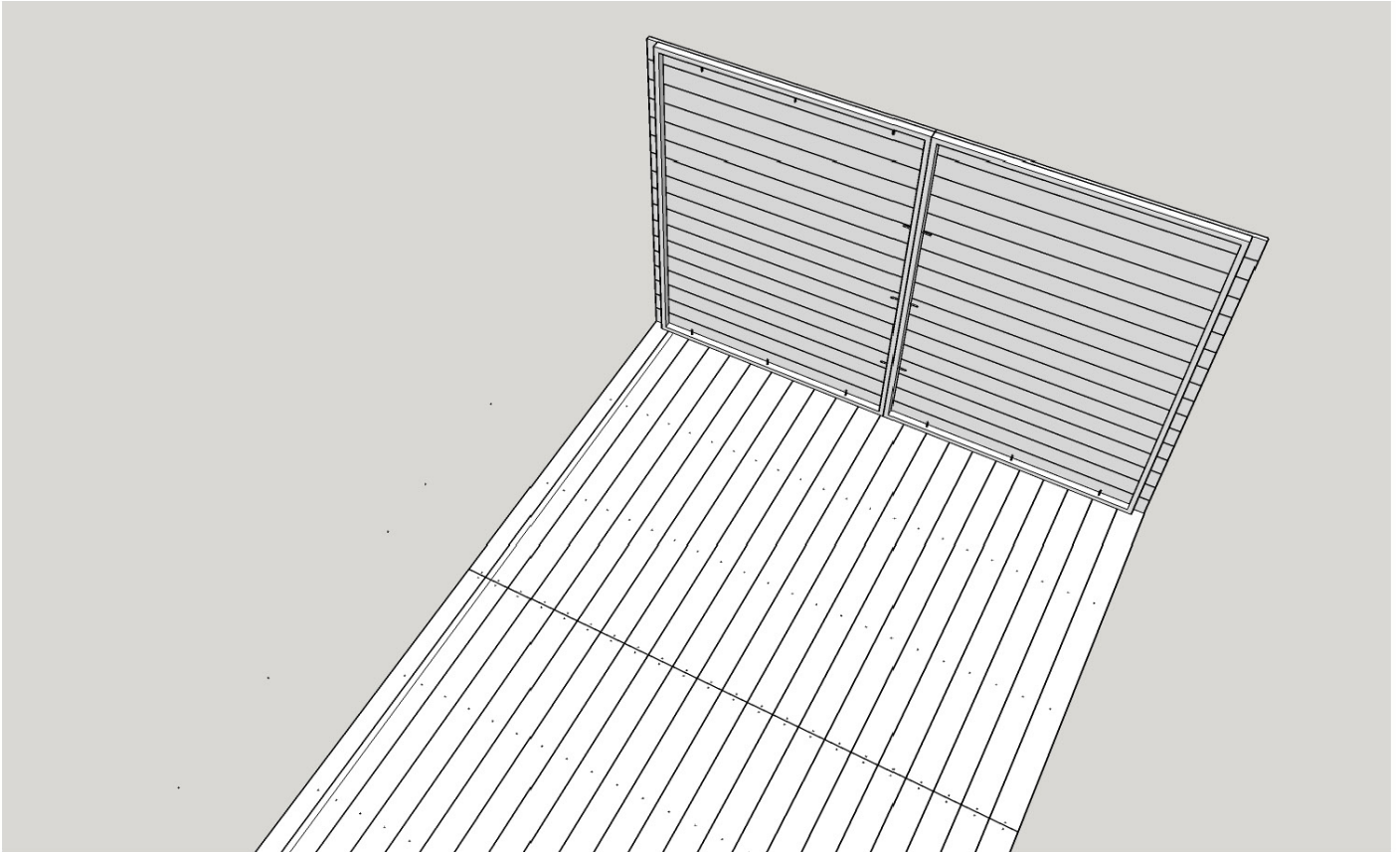

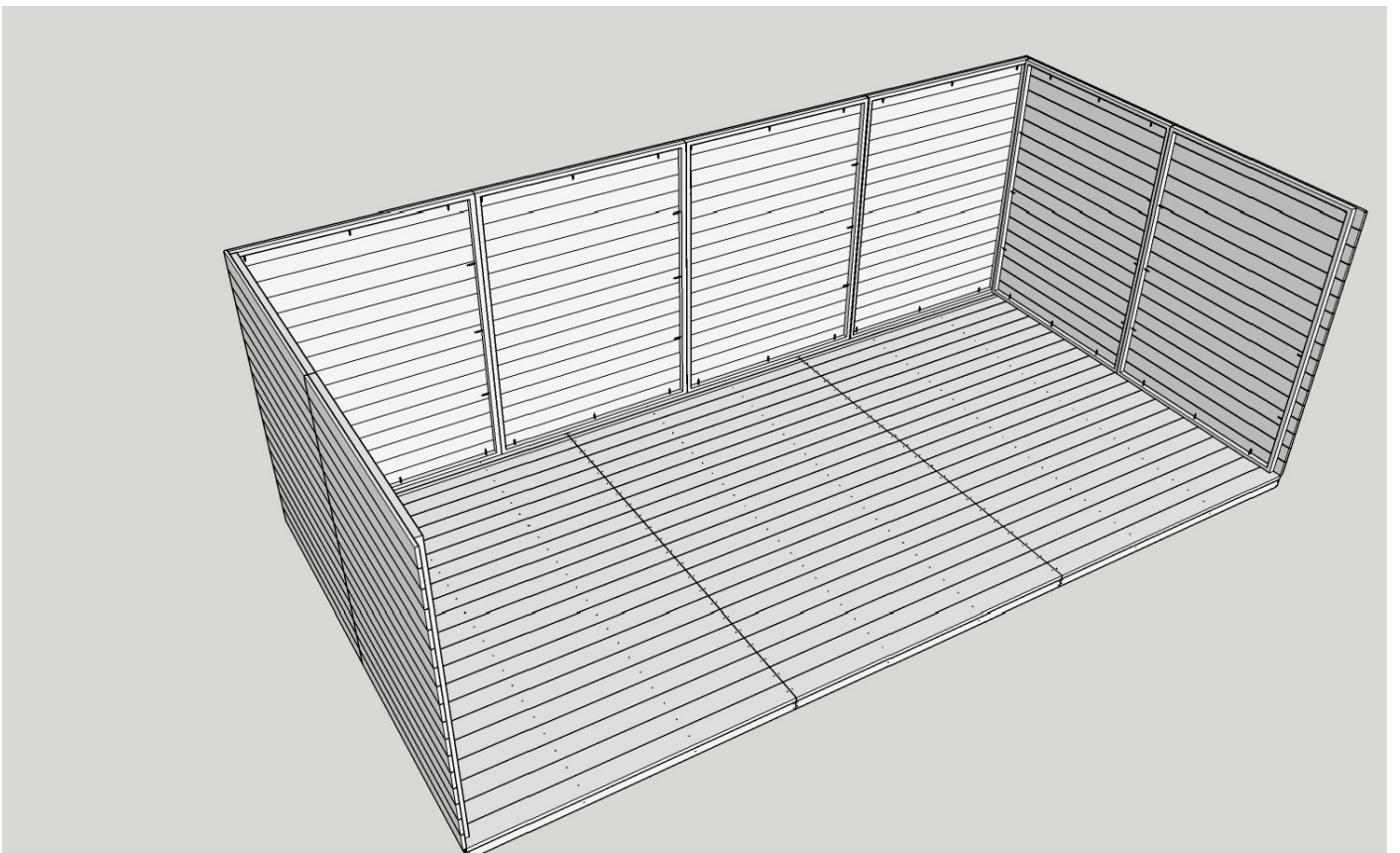
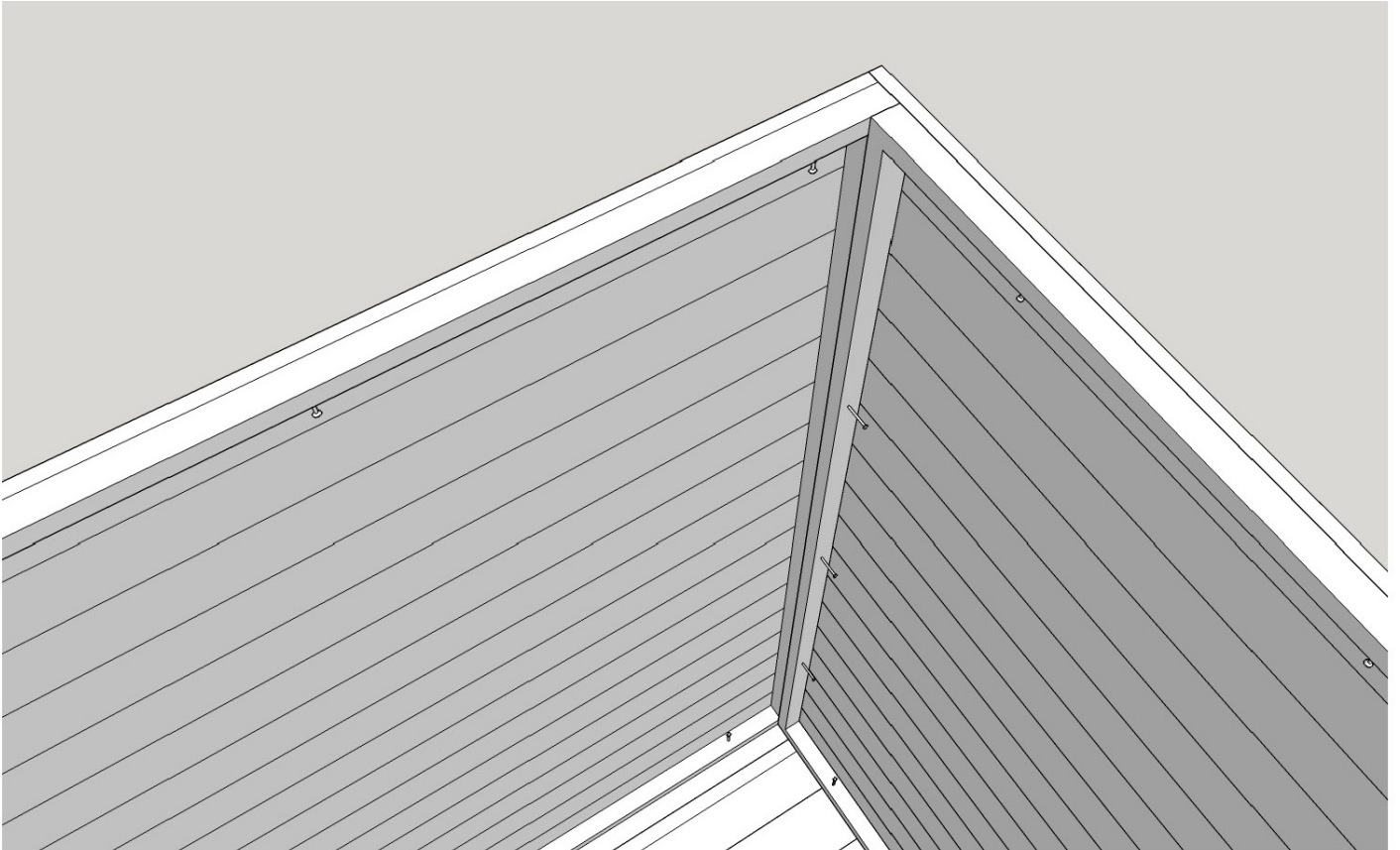

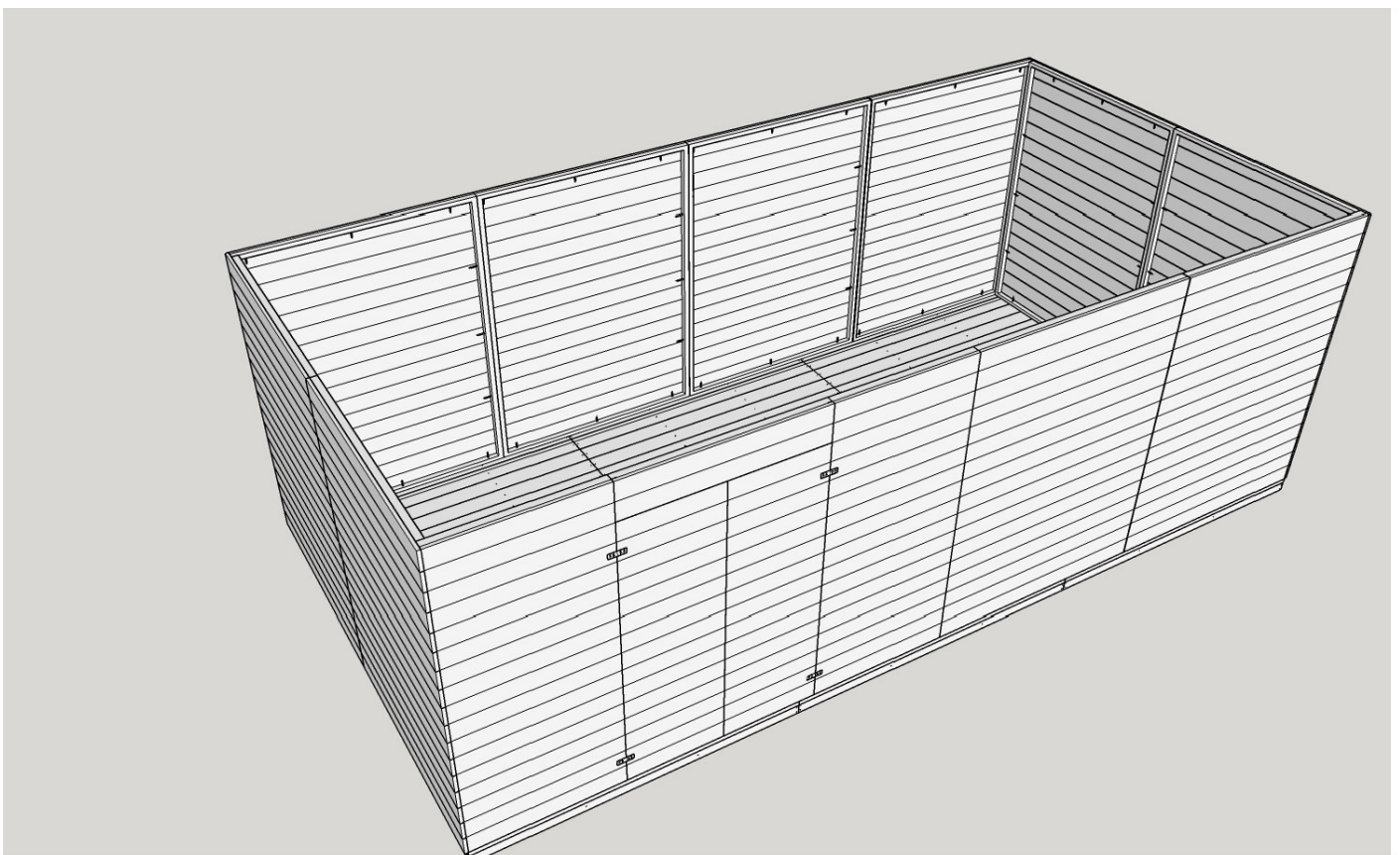
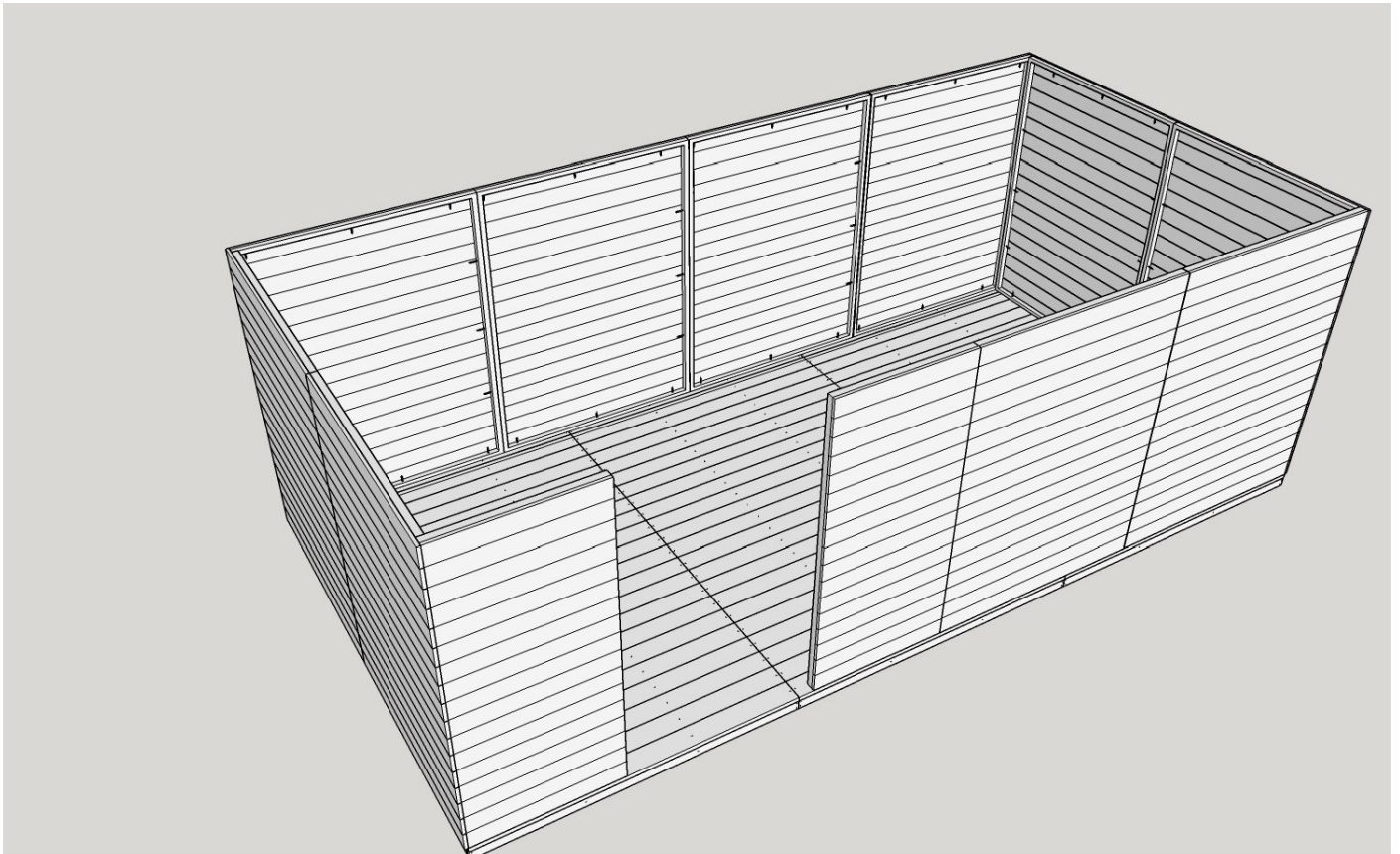

Uloženie konštrukcie strechy

Bočný trojuholník

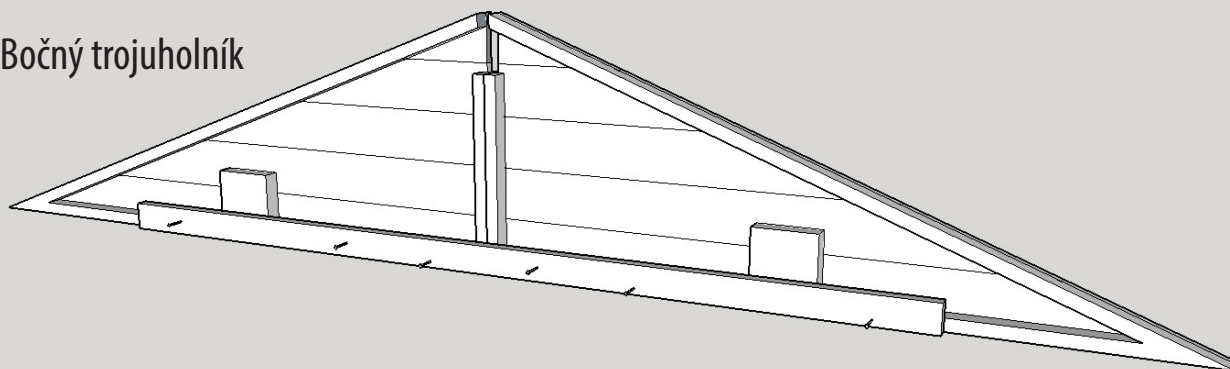

Vnútorý trojuholník

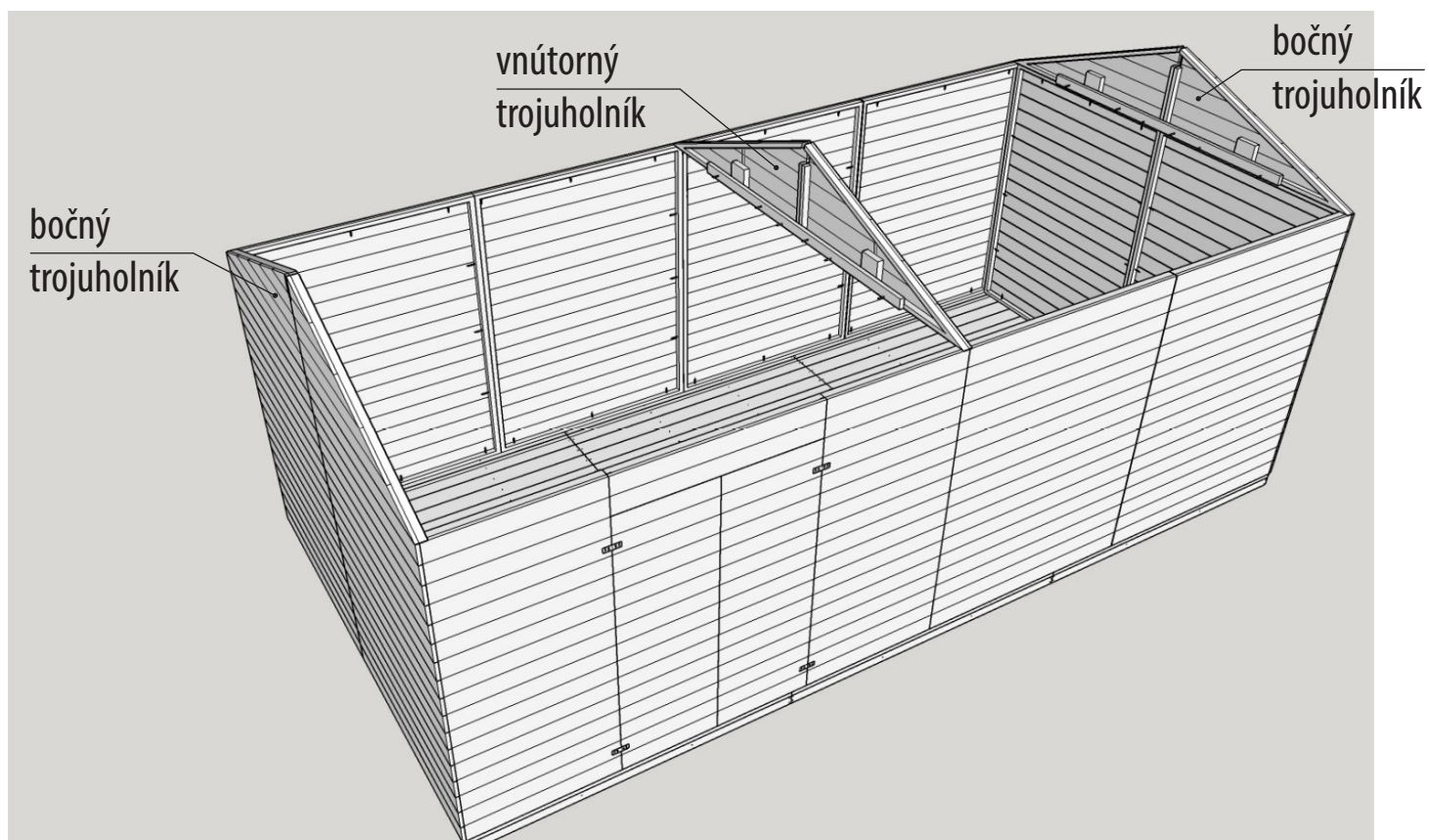
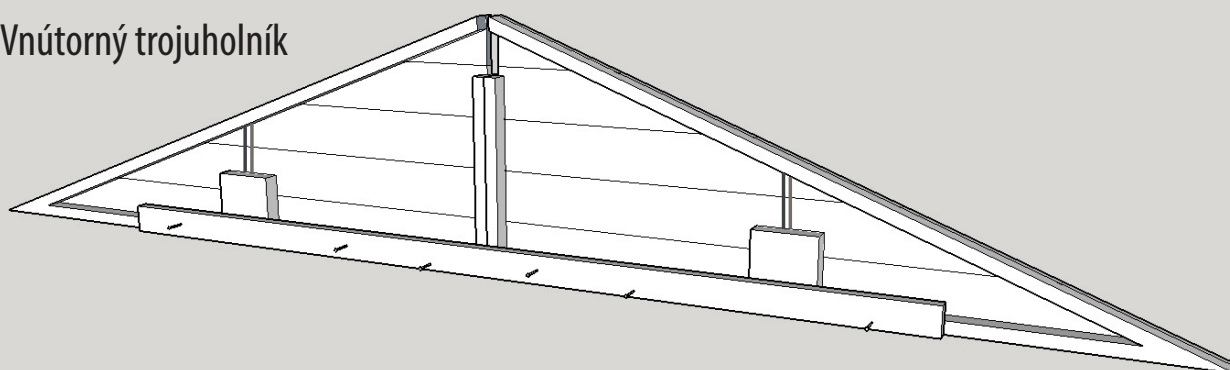

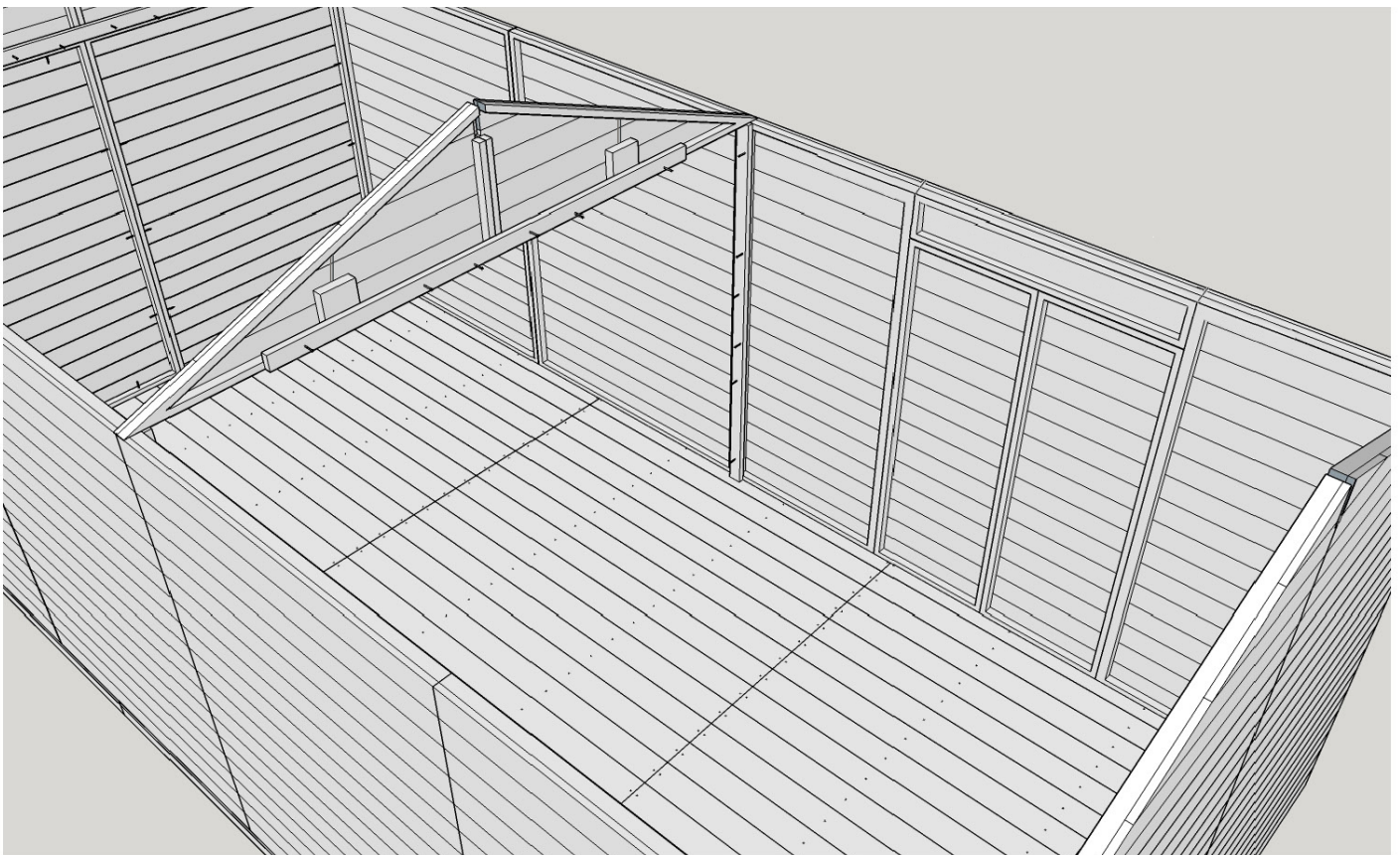
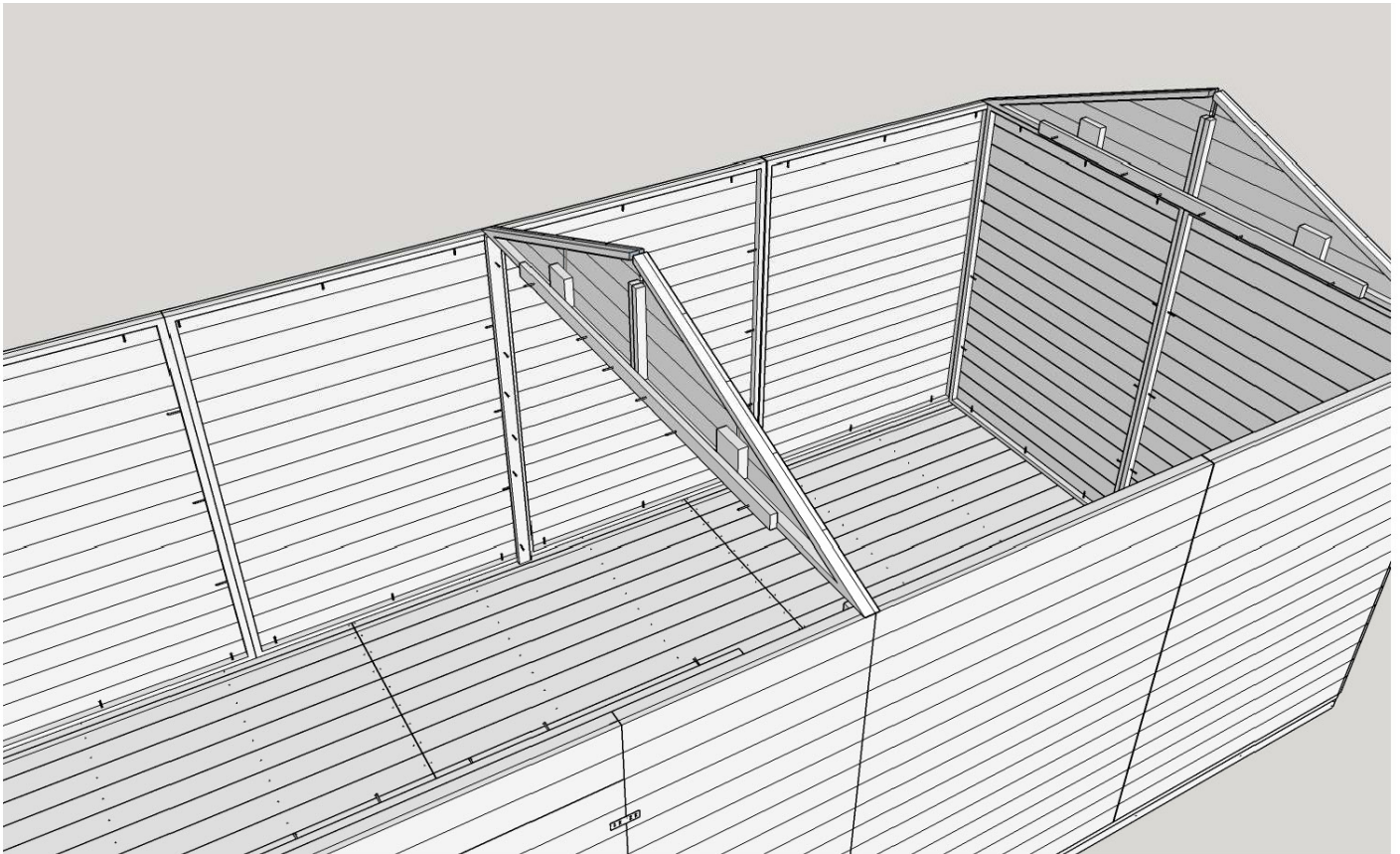

Stredová krokva

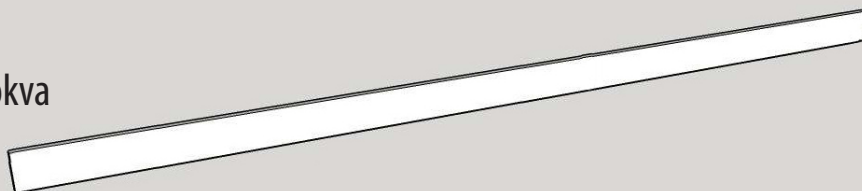

Bočná krokva

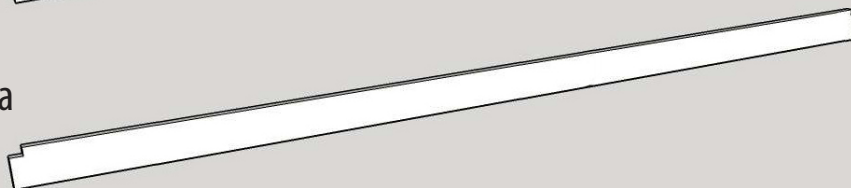

Nadstavované krokvy

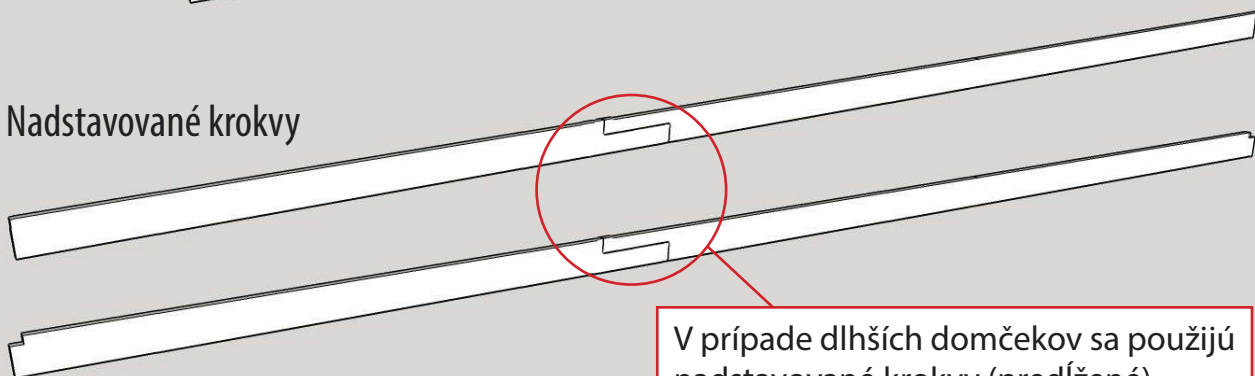

V prípade dlhších domčekov sa použijú nadstavované krokvy (predĺžené).

Bočná
krokva

Stredová
krokva

Bočná
krokva

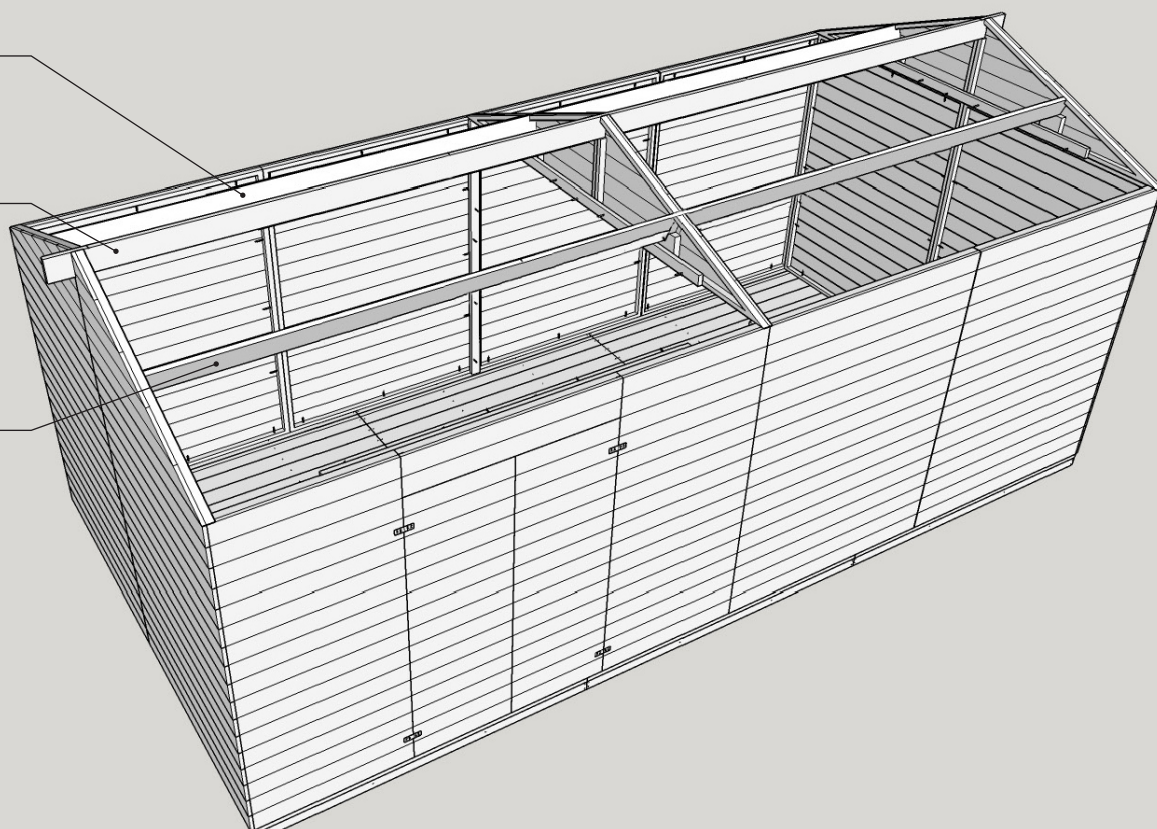

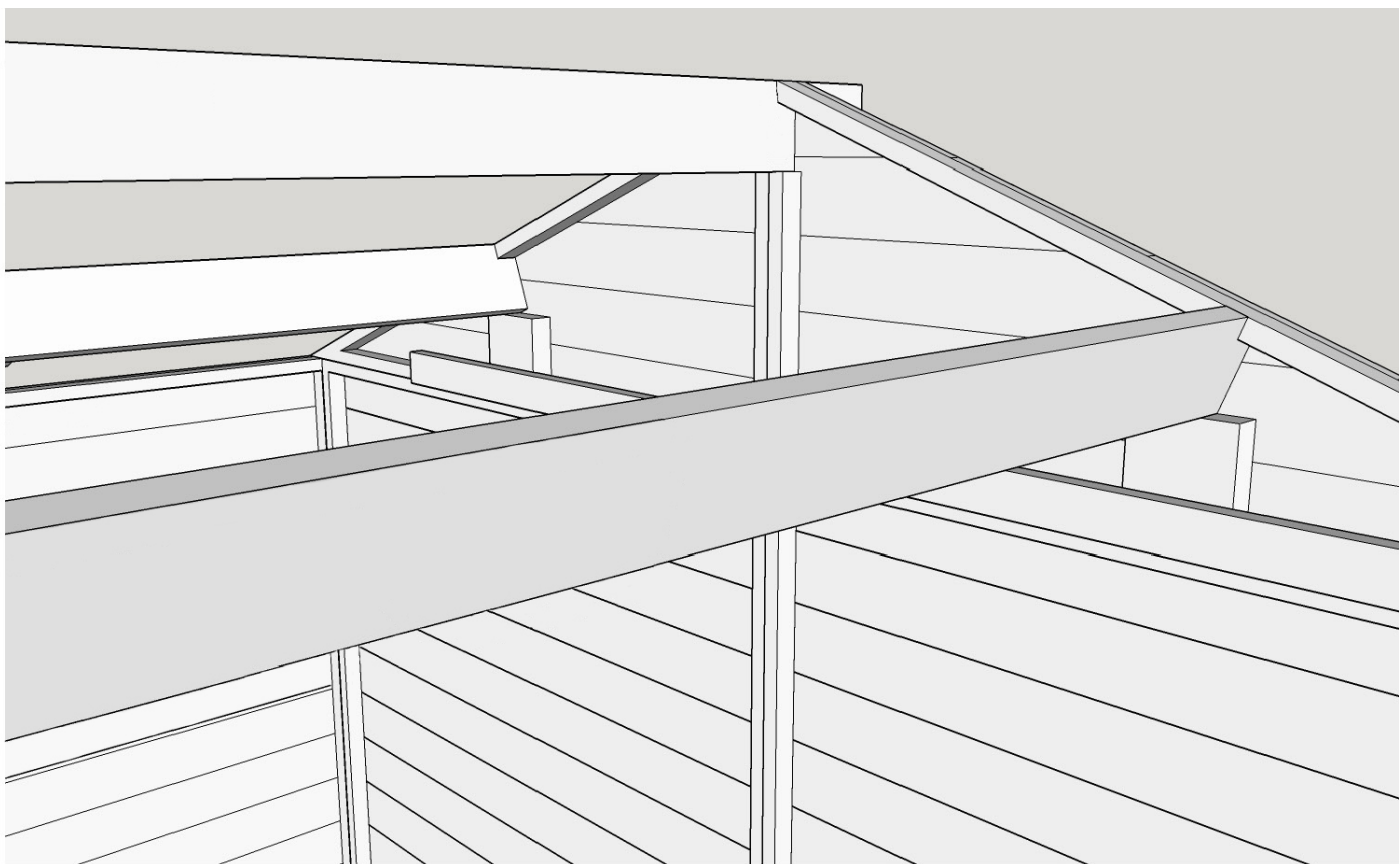

Uloženie pokrytia strechy

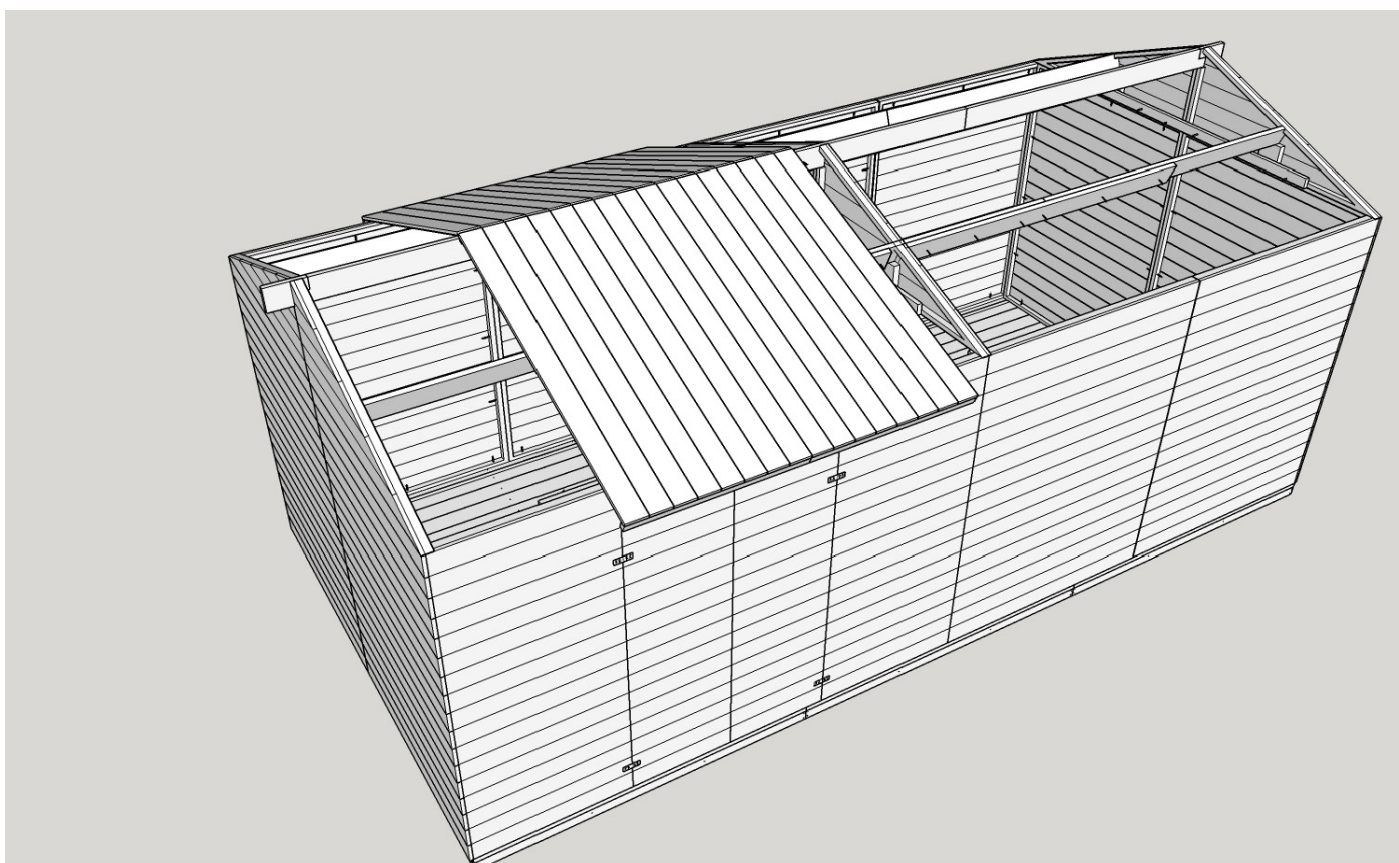

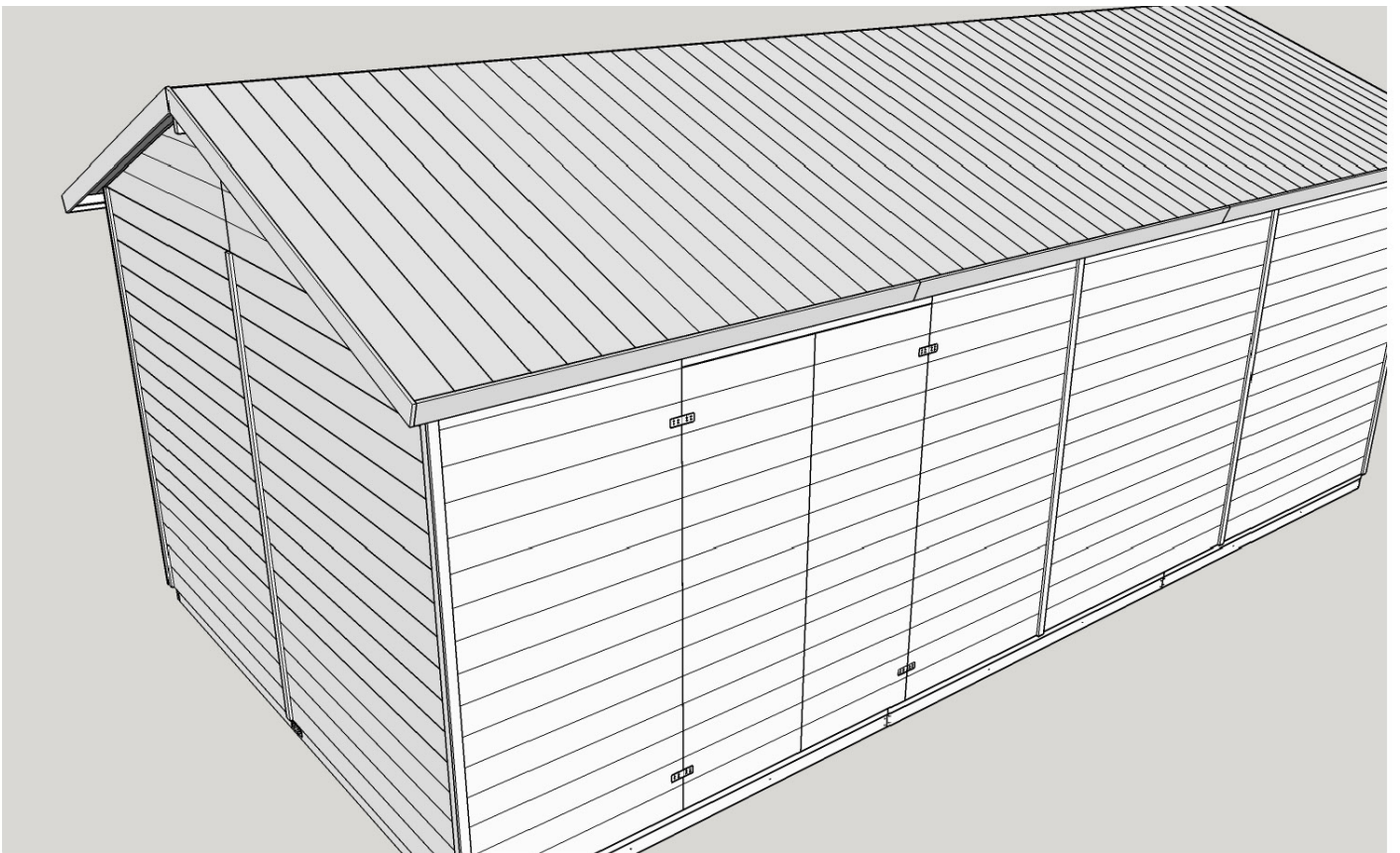
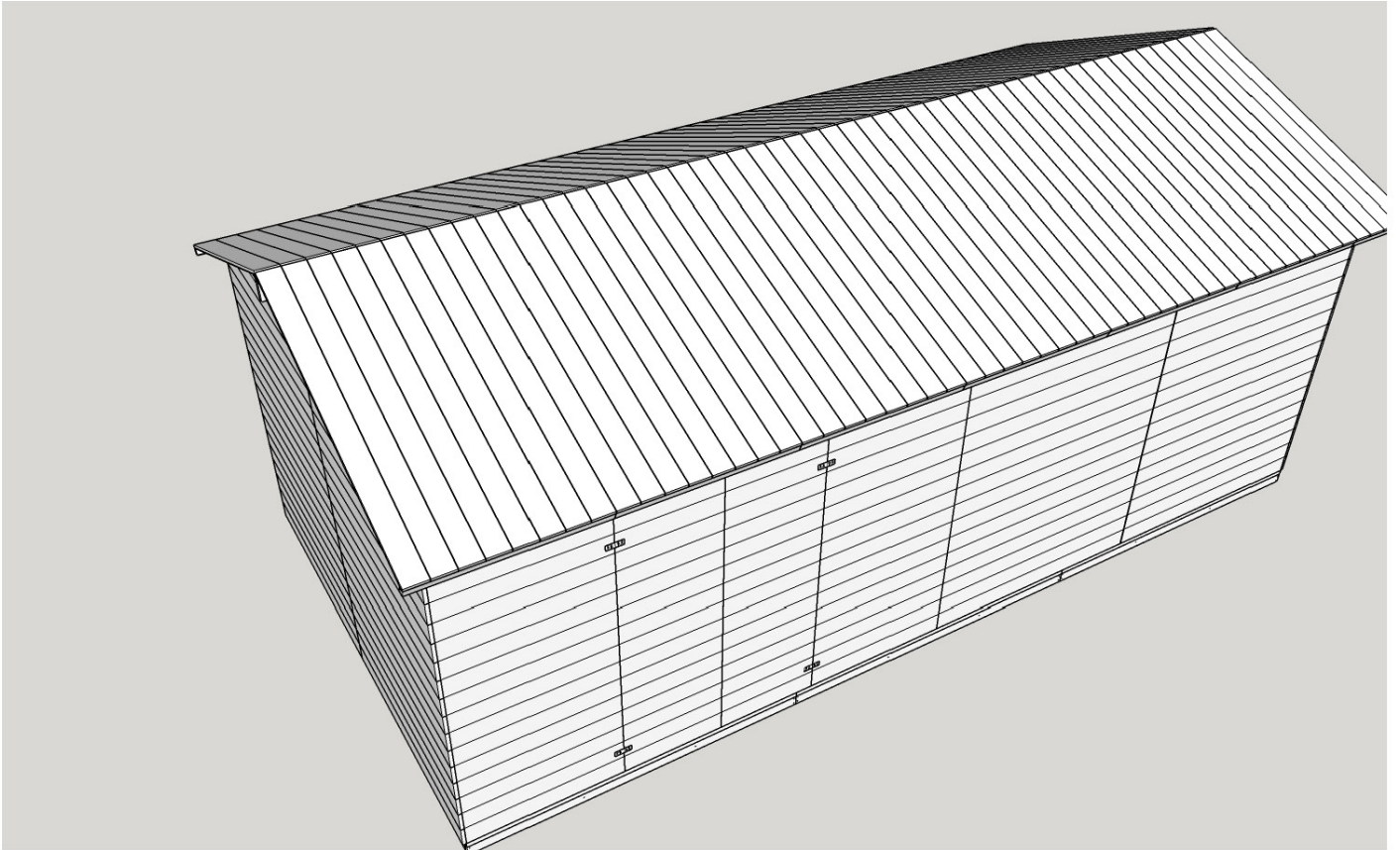

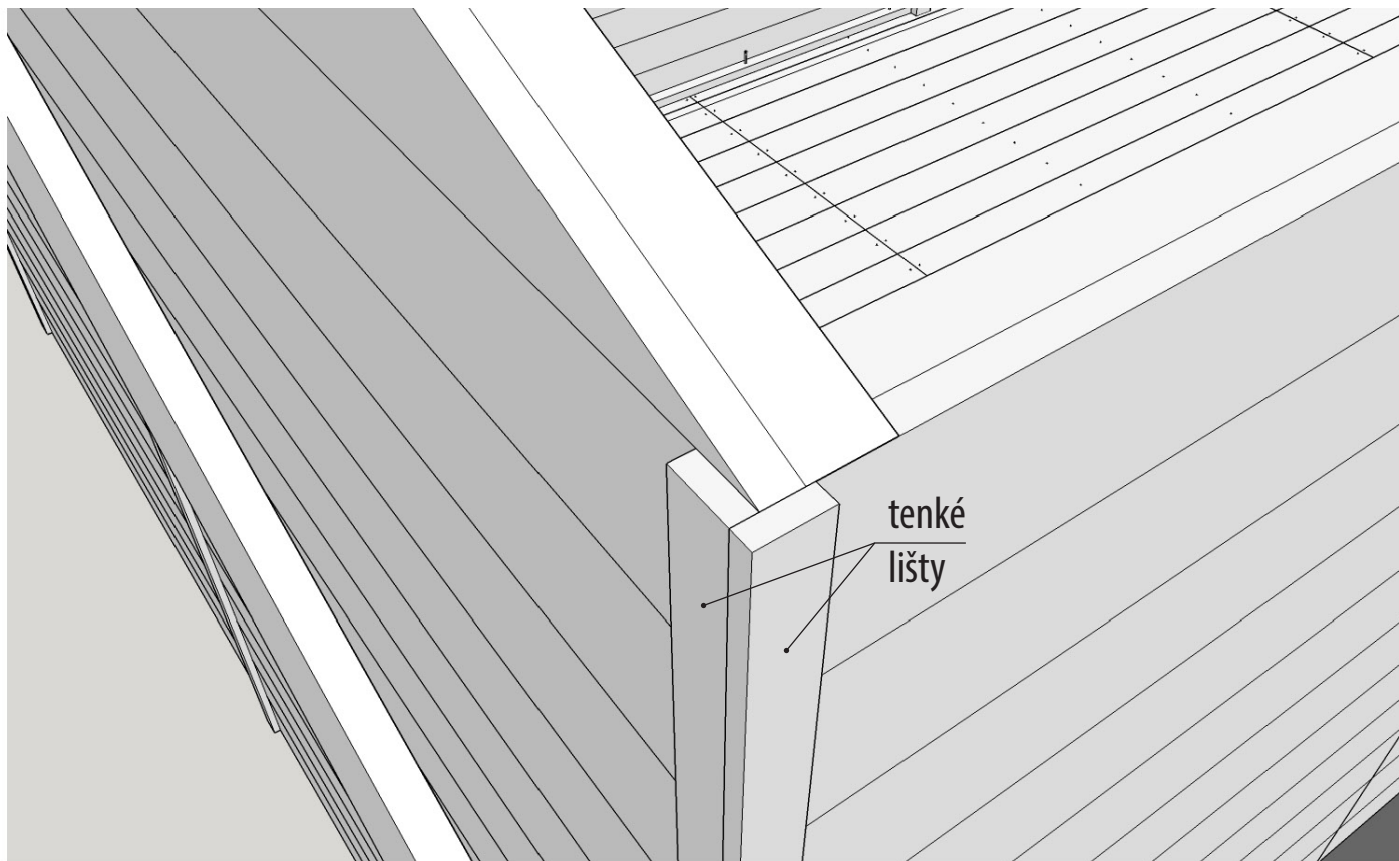

Postup pri kladení asfaltovej izolácie

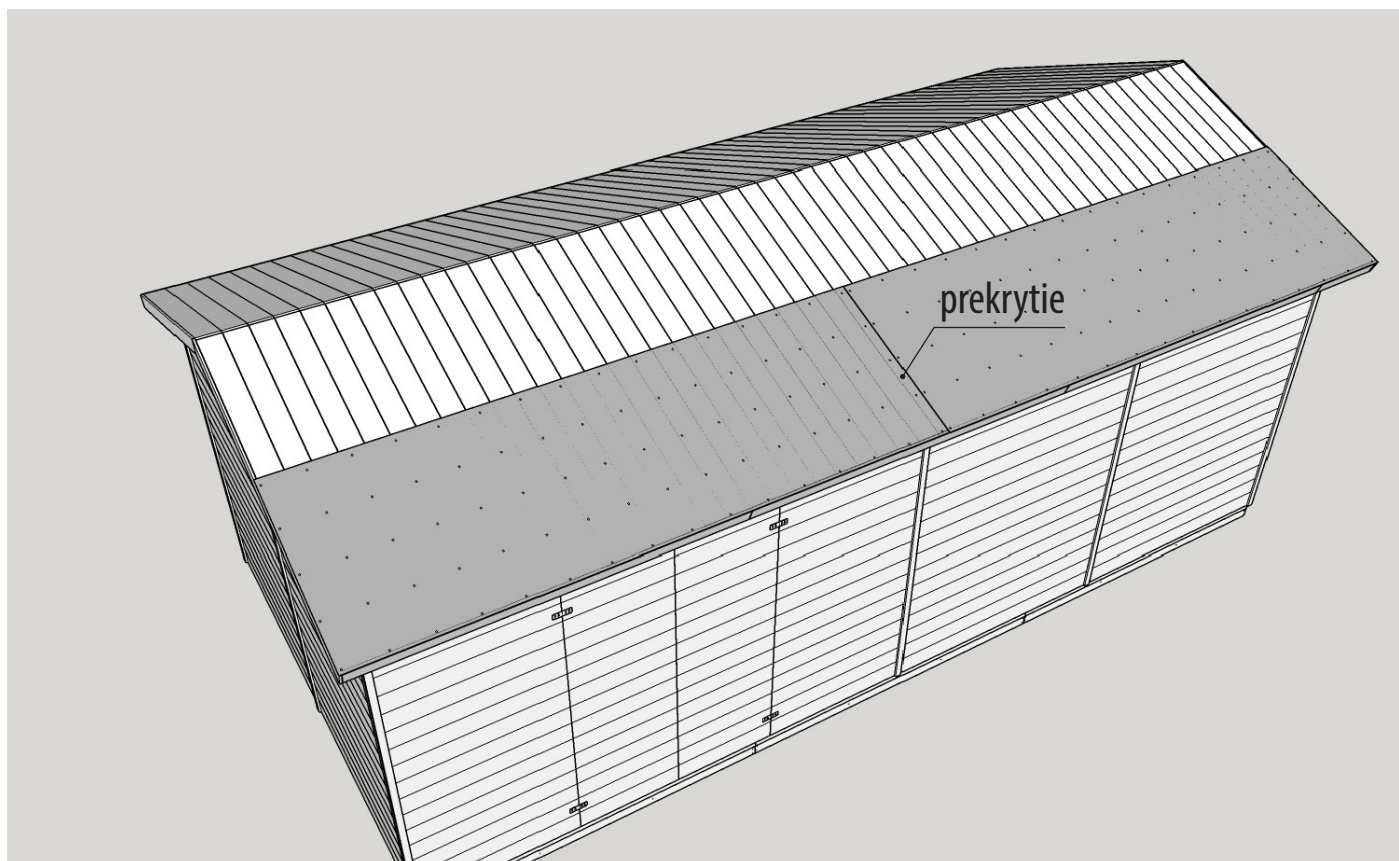

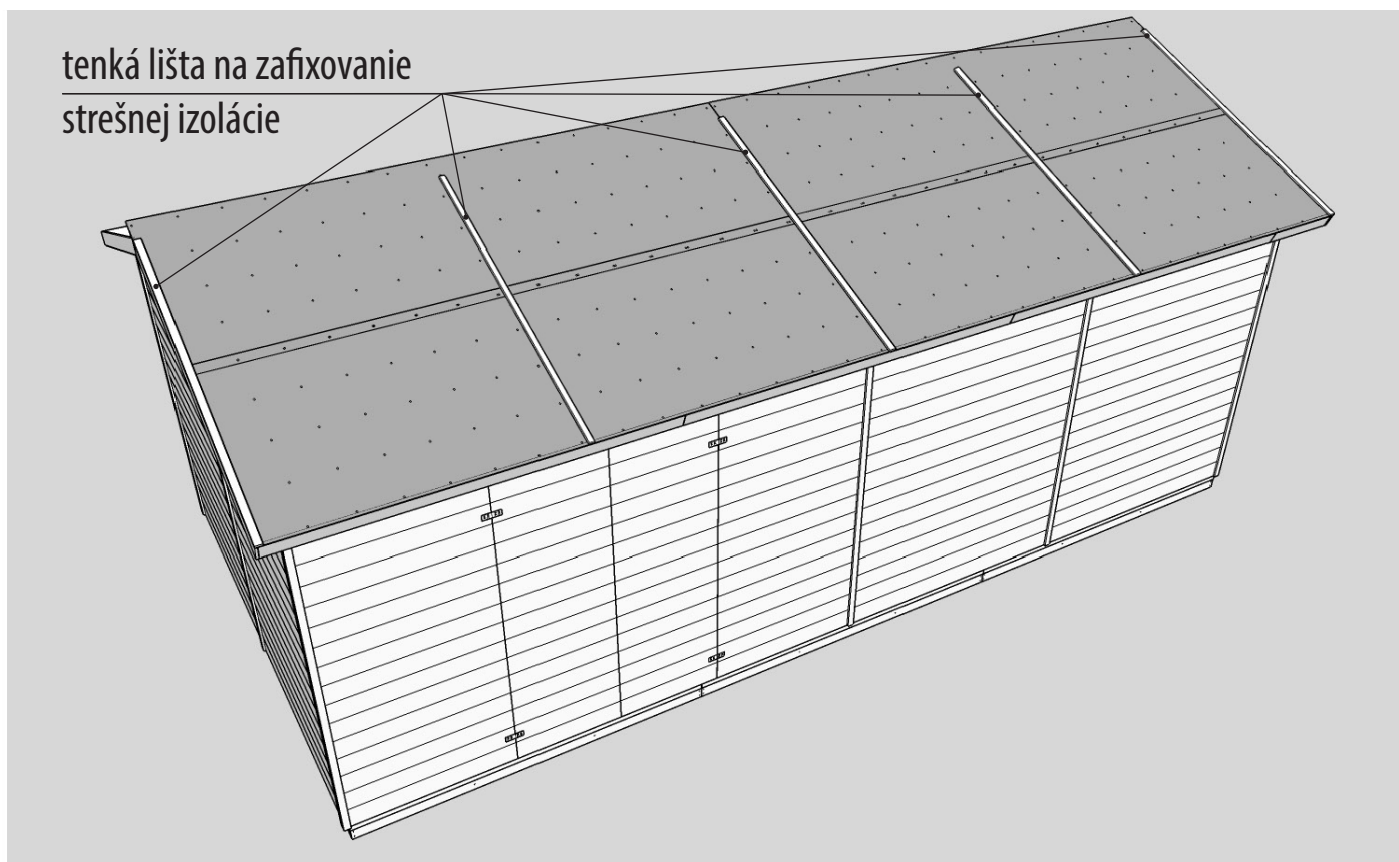
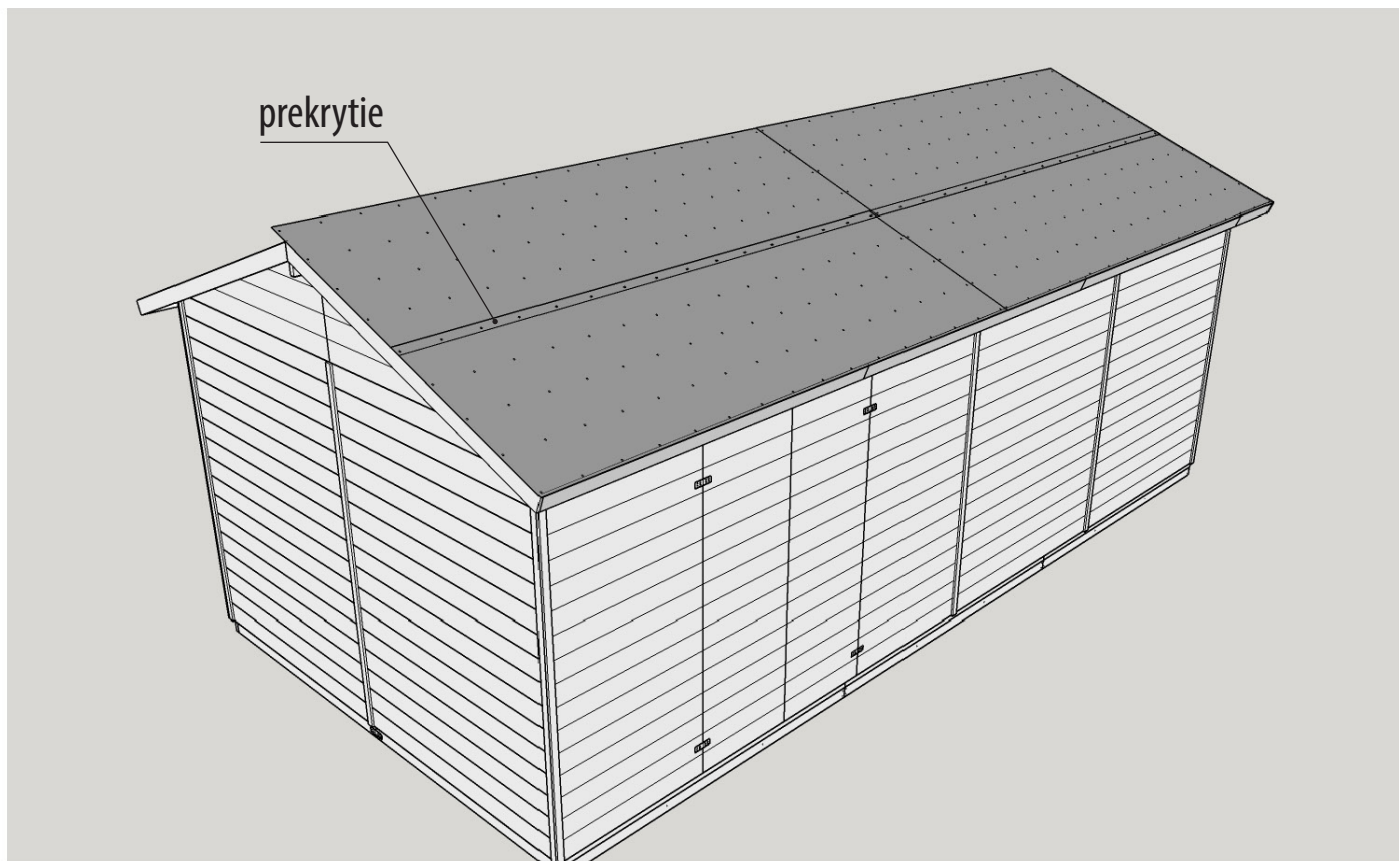

Ďakujeme za výber
záhradného domčka z našej spoločnosti
a prajeme spokojné užívanie.

Záhradné domčeky
MICHAL ZELMAN

www.domceknazahradu.sk